

# VIDEO DOOR PHONE

Model No. APV-4PM

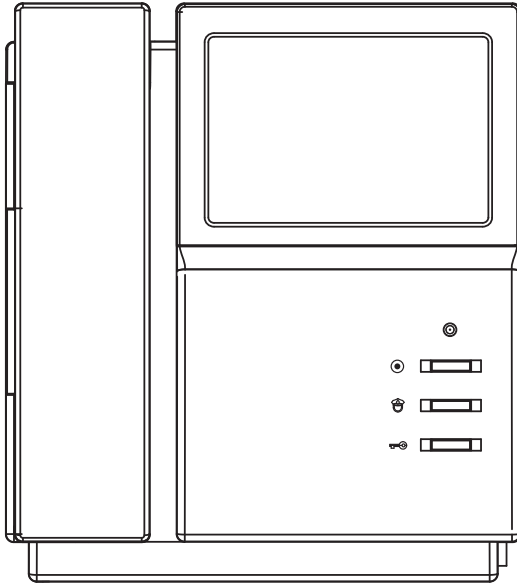

## COMMAX Co.,Ltd.

- Thank you for purchasing our COMMAX product.
- Please carefully read this User's Guide (in particular, precautions for safety) before using the product and follow the instructions to use your product exactly.
- The company is not responsible for any safety accidents caused in abnormal operation of the product.

## Table of Contents

<b>Warnings and caution</b> .....	<b>2</b>
<b>Features &amp; Specifications</b> .....	<b>4</b>
<b>Part Name &amp; Function</b> .....	<b>5</b>
<b>Multi Entry Panel Calling</b> .....	<b>6</b>
<b>Sub unit calling (Intercommunication)</b> .....	<b>6</b>
<b>Guard station or external area calling</b> .....	<b>6</b>
<b>Call/ Talk duration</b> .....	<b>7</b>
<b>Setting In-House unit as a Master and Sub Unite</b> .....	<b>7</b>
<b>Chime sound</b> .....	<b>8</b>
<b>Changing and initialization of the password</b> .....	<b>8</b>
<b>Opening the entrance of a Multi-entry Panel With Password</b> .....	<b>9</b>
<b>Wiring</b> .....	<b>10</b>
<b>System diagram</b> .....	<b>11</b>

# Warnings and caution

◎ Make sure to follow the instructions to prevent any danger or property losses.



**Warning**  
Death or serious injury is expected.

- It indicates prohibition.
- It indicates prohibition of disassembly.
- It indicates prohibition of contact.
- It indicates dos and don'ts.
- It indicates that the plug should be pulled out from the socket.



**Warning**

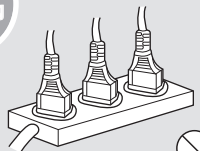

**Do not put the plug in the socket simultaneously.**  
It may generate abnormal heat or cause a fire.

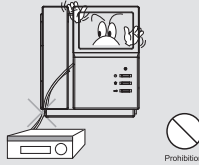

**Do not connect to other products while in use.**  
It may cause breakdown.

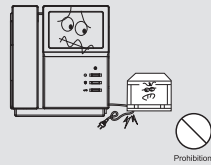

**Do not forcibly bend the cord or put a heavy object on the product.**  
It may cause a fire.

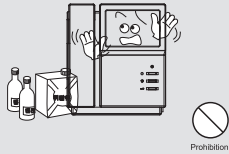

**Do not use water, thinner or a detergent used to wash oil products when you wash the exterior.**  
Make sure to wash it by using a dry cloth to prevent any breakdown or electric shock.

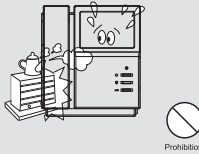

**Do not install the product in a humid place.**  
It may cause an electric shock or a fire.

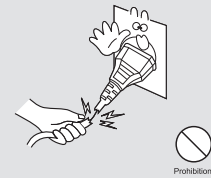

**Do not forcibly pull out the cord from the socket.**  
If the cord is damaged, it may cause a fire or an electric shock.



**Do not put the plug in the socket with a wet hand.**  
It may cause an electric shock.

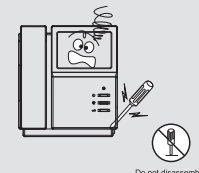

**Do not disassemble, repair or modify the product.**  
It may cause a fire, an electric shock or an injury due to malfunction of the product.

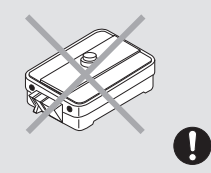

**Do not use AC circuit breaker.**  
It may cause an electric shock.

# Warnings and caution



**Caution**  
An injury or property losses are expected

- It indicates prohibition.
- It indicates prohibition of disassembly.
- It indicates prohibition of contact.
- It indicates dos and don'ts.
- It indicates that the plug should be pulled out from the socket.



**Caution**

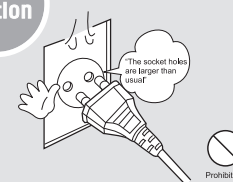

**If the socket holes are larger than normal, do not put the plug.**  
It may cause an electric shock or a fire.

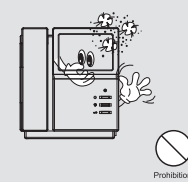

**Make sure that dust or foreign substances are not gathered on the product.**

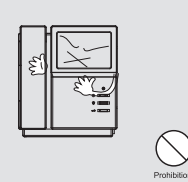

**Make sure to prevent foreign substances from entering the product.**  
It may cause a breakdown.

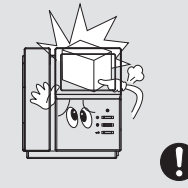

**Do not put a heavy object on the product.**  
It may cause a breakdown.

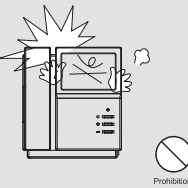

**Do not disassemble or give an impact to the product.**

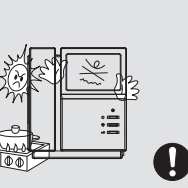

**Avoid direct rays of the sun or heating devices at a time of installation.**

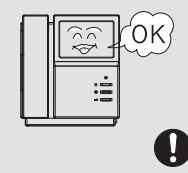

**Install the product in a flat and stable place.**  
Otherwise, it may not function properly.

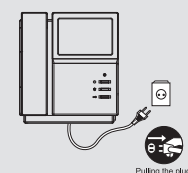

**Pull the plug if the product is not used for a long time.**

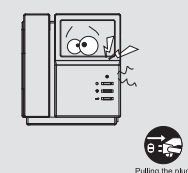

**If the product generates strange sound, make sure to pull the plug immediately and contact Commax service center.**

# 1. Features & Specifications

## This is a DC type B/W Video phone.

It can add up to a maximum of 2 sub units in each residence and is a surface mount type video phone that connects to a guard station or external area. It's functions include Door release and intercommunicating

### 1) Features

- ① DC type B/W video phone
- ② When installing only 1 master unit, a power is supplied from a Floor distributor without an additional power supply.
- ③ Sub monitors need an extra power source.
- ④ 4" CRT Monitor
- ⑤ 3 buttons : "Guard station call", "door release" and "extension call".
- ⑥ COMMAX chime(Sol, Mi, Do) is the ring tone call sound from Multi Entry Panel  
And there is a doorbell Ding-Dong sound from a individual door
- ⑦ Entrance release
- ⑧ 6 wires UTP Cable (CAT.5) including power source.

### 2. Specifications

ITEMS	APV-4PM
Wiring	Floor distributor: 6 wires (TALK2, DATA1, POWER1, VIDEO1, GND1)
Power Voltage	DC24V~28V / 5A (Master: Supplied from floor Distributor) (Slave: Extra power source is required)
Transmission Method	Full duplex
Screen Dimension	4" CRT
Power requirements	Stand by : 60mA/ Maximum operation :600mA
Distance range	Between Floor Distributor and In-house unit UTP ( ∅ 0.5) 50m

# 2. Parts names & Function

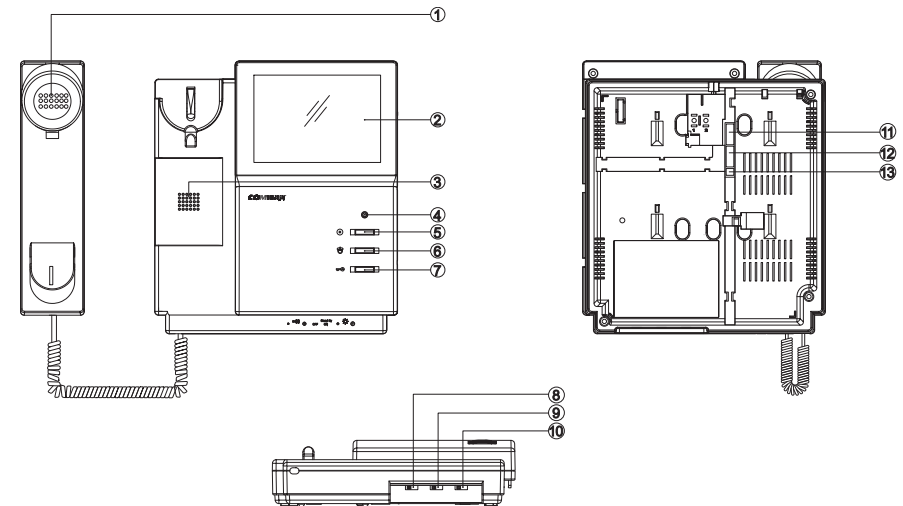

No.	Details	No.	Details
1	Handset	8	Call volume control
2	CRT Screen	9	Power switch
3	Speaker	10	Video brightness control
4	Power Lamp	11	Connecting terminal to Floor distributor
5	Extension call button	12	Connecting terminal to sub unit
6	Guard station call button	13	Connecting terminal to Audio type Door bell
7	Door release button		

- ♣ This is an in-house unit which is a B/W video phone.  
Up to 4 residences are connectable with a single Floor distributor through a Building Distributor connected with the Multi Entry Panel.  
Each residence can add 2 sub-units, which comes to 3 units in total including master unit.

### 3. Multi Entry Panel Calling

- ① When calling from the Multi-Entry Panel, you will hear the COMMAX chime and the image of the visitor will be shown on the screen
- ② Pick up the handset to initiate conversation.
- ③ When opening the door of the Multi Entry Panel during a conversation, press the “Door release” button and the entrance will open.  
(The call conversation is ended right after the release of the door)
- ④ When conversation is over, hang up the handset.

### 4. Sub unit calling (Intercommunication)

- ① Pick up the handset and, press the “extension call button”, to call to the sub unit.
- ② When the sub unit responds, conversation occurs.  
(calling both the Extension and Master unit is possible)
- ※ when calling to Guard station with another unit or while talking with other Extension, another in-house unit can not make a call.
- ③ while talking with another extension unit and an incoming call from the Multi-Entry panel arrives,
- ④ If this time, you have 30secnds to answer the call from the Multi-Entry panel by pressing the hook switch once on the extention unit(only one extension unit can have a conversation with Multi-Entry panel at a time)

### 5. Guard station or external area calling

- ① Pick up the handset and press the “Guard call” button to call the Guard Station.
- ② When the guard station responds, conversation can occurs.
  - \* The Guard station unit does not have a calling function, only receiving)
  - \* If the Guard unit is on the line with another residence or Multi entry unit, you will hear a busy tone)

### 6. Call/ Talk duration

This is applied to all calls and conversation.

- ① Calling time lasts for 30 second.
- ② Talking duration lasts for 60 second.

### 7. Setting In-House unit as a Master and Sub Unit

- This setting should be set by Muliti entry panel which should be connected to chanel 1
- when a single unit is installed, the setting should be set as a master unit.  
in case more than 2 unit are installed one should be set as the master, and the rest should be set as slave unit
- The “Door Release” and “Extension” button on the unit run as a selection to master or slave in this mode

#### 1) Setting Master

- ① Set the ID as “0” on Multi-Entry panel which shold be connected to chanel 1
  - The default of all Multi Entry Panels is assigned to “0”.
- ② While picking up the handset of an in-house unit, press the “extension call” button and the “door release” button at the same time.
- ③ You can communicate with the Multi Entry Panel while the resident’ s number is displayed on it.
- ④ When the “\*\*\* -> M” message is displayed on the Multi Entry Panel when you press the “Door Open” button on an in-house unit.
- ⑤ Then, register the ID of the shown residence, and press “” button to hear a sound of completion.
- ⑥ The registration is complete when you hang up the handset.  
(Repeat this process for other residentes)
- ⑦ Set the ID’ as “1” on the Multi-Entry panel after completing the registration

#### 2) Setting the Sub-Unit

- ① Set the ID as “0” Multi-Entry panel which shold be connected to chanel 1
  - The default of all Multi Entry Panels is assigned to “0”
- ② While picking up the handset of an in-house unit, press “extension call” button and the “door open” button at the same time.
- ③ You can communicate with Multi Entry Panel while the resident’ s number displayed on it.
- ④ When the “\*\*\* -> S” message is displayed on the Multi Entry Panel when you press the “Extension call” button on the in-house unit.

- ⑤ Then, register the ID of the said residence, and press “

## 8. Chime sound

Chime will sound when calling an individual door bell with audio type.

## 9. Changing and initialization of the password

Note) The doors do not open by default password “1234” .  
Only after changing default Password, can you use this function

### 1) Initialization for the password (only the password for the Master unit is initialized)

- ① Shut off master unit and turn it on again while holding the “extension call” button and “Door release” button at the same time for 3 seconds at the same time.
- ② The password will initialize to “1234” when the blink of LED stops.

Note : Default password : 1234

### 2) Changing Resident Password(From Multi Entry Panel)

- ① Hold “Residence Number” and “

## 10. Opening the entrance of a Multi-entry Panel With Password

Note) The doors do not open by default password “1234” .  
Only after changing default Password, can you use this function

### 1) Open the entrance with resident password

- ① Press resident number” and “

### 2) Open the entrance with Building password

- ① Enter “9900” and “

8



# 11. Wiring

## 1) Wiring method

- Please pay attention to the polarity of the wires.  
Units will not work properly when mis-wired
- \* Use UTP(CAT.5) cable and be careful to match the color of the wires shown to the left
- The Power of the Master unit supplied from the Floor distributor without an additional power supply, but additional sub units are needed separate a power source.  
(There is no power line connection between Mast unit and Sub units)

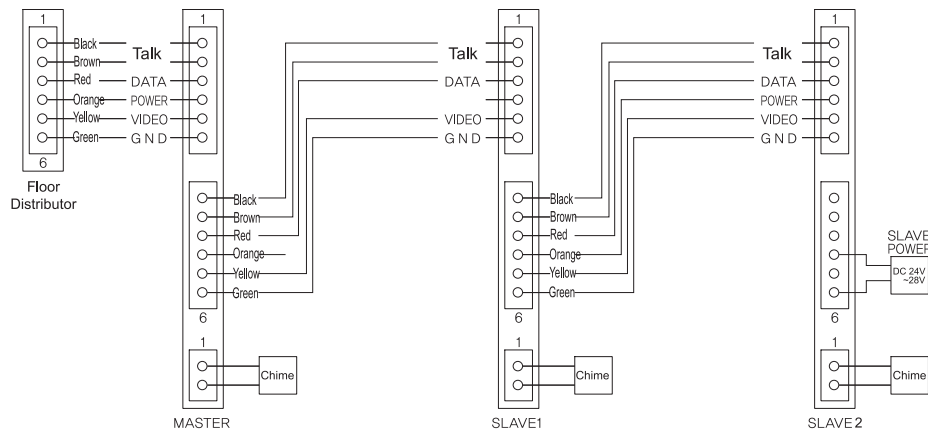

CCU-FS		UTP(CAT.5) (TWIST PAIR)		APV-4PM	
1	Black	Stripe orange	Stripe orange	Black	1
2	Brown	Orange	Orange	Brown	2
3	Red	Stripe green	Stripe green	Red	3
4	Orange	Green	Green	Orange	4
5	Yellow	Stripe Blue	Stripe Blue	Yellow	5
6	Green	Blue	Blue	Green	6



# 12. System diagram

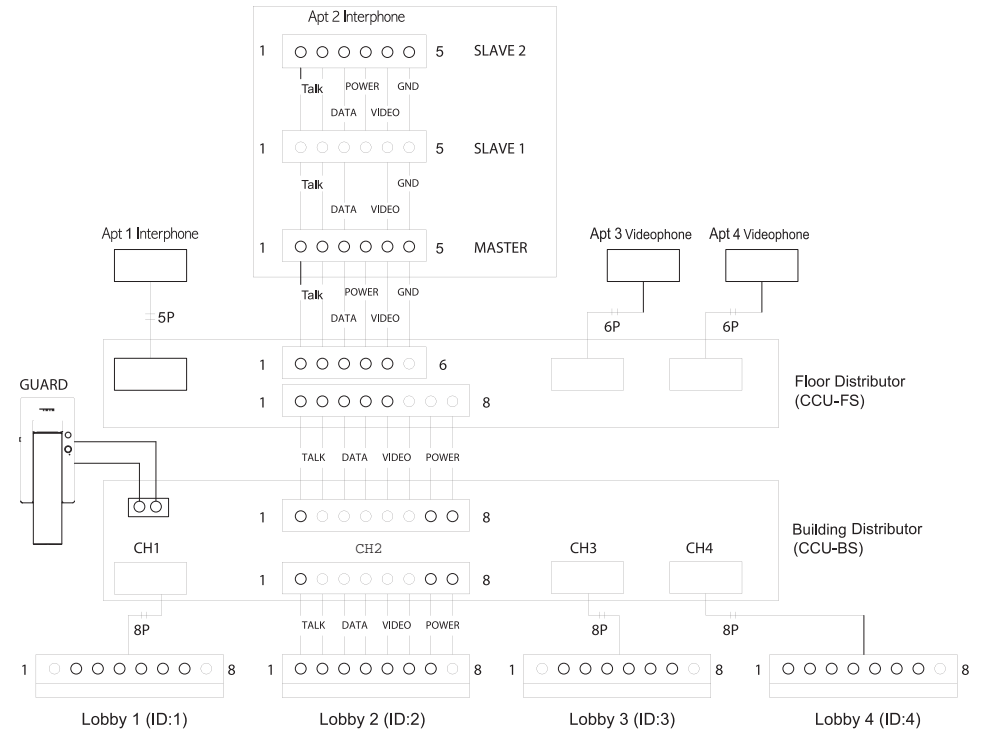



**COMMAX Co.,Ltd.**

a513-11, Sangdaewon-dong, Jungwon-gu, Seongnam-si, Gyeonggi-do, Korea

Int'l Business Dept. : Tel.; +82-31-7393-540~550 Fax.; +82-31-745-2133

Web site : [www.commax.com](http://www.commax.com)

Printed In Korea/ 2007.10